

A leader in design,
manufacturing and
distribution of top
quality aluminum
building products
throughout the South
Eastern United States
for over 30 years.

10530/BAL
Buyline 5273

Walkway, Carport and Patio Covers



Ballew's

Aluminum Products Inc.

Quality Products Since 1958

Toll Free 1-800-231-6666

Local 1-864-272-4453

Fax 1-864-272-4456

Roll Formed Canopy Systems

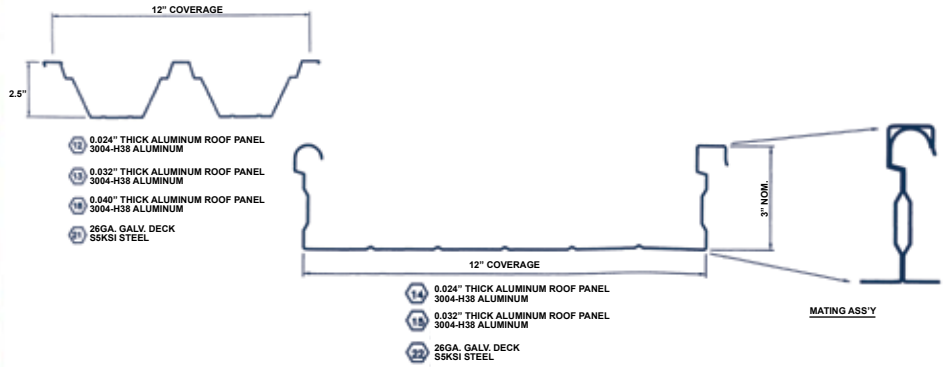

UNIT TYPE 1

| PROJECTION | LIVE LOAD – PSF ROOF PANELS | | | |
|------------|-----------------------------|------|------|-------------|
| | .024 | .032 | .040 | 26 GA STEEL |
| 6.0 | 55 | 55 | 55 | 55 |
| 8.0 | 37 | 55 | 55 | 55 |
| 10.0 | 23 | 39 | 55 | 47 |
| 12.0 | 16 | 26 | 40 | 31 |
| 14.0 | 11 | 17 | 25 | 19 |

UNIT TYPE 3

| PROJECTION | SPAN | OVER-HANG | LIVE LOAD – PSF ROOF PANELS | | | |
|------------|------|-----------|-----------------------------|------|------|-------------|
| | | | .024 | .032 | .040 | 26 GA STEEL |
| 6.0 | 4.0 | 1.0 | 55 | 55 | 55 | 55 |
| 9.0 | 6.0 | 1.5 | 55 | 55 | 55 | 55 |
| 12.0 | 8.0 | 2.0 | 55 | 55 | 55 | 55 |
| 18.0 | 12.0 | 3.0 | 32 | 40 | 54 | 40 |
| 21.0 | 14.0 | 3.5 | 23 | 29 | 39 | 32 |

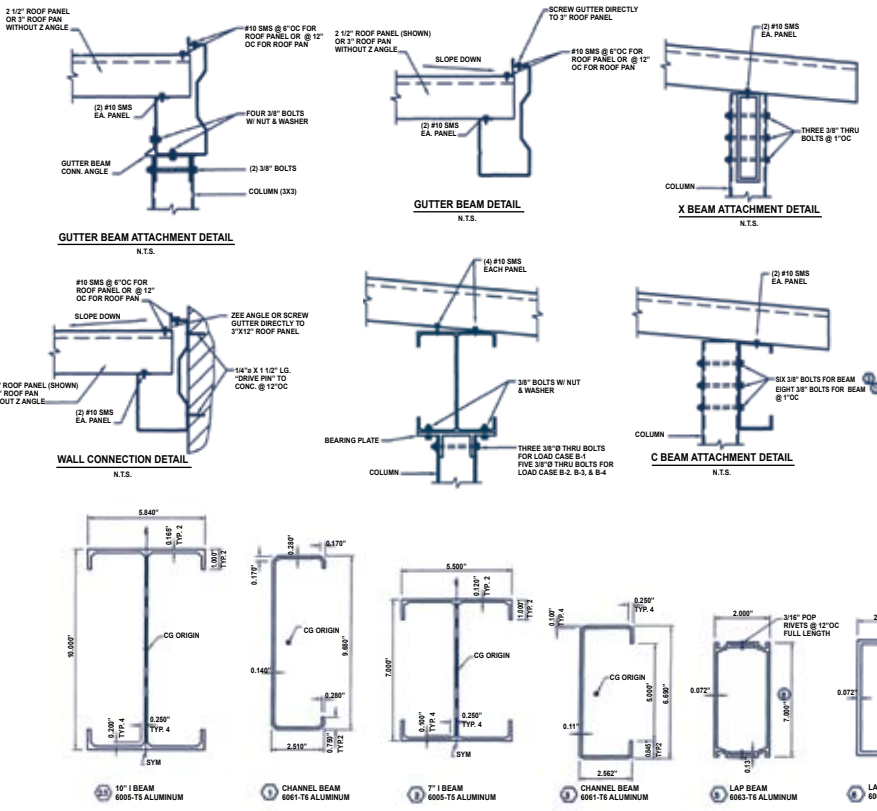

RESTRAINED COLUMN SCHEDULE

| ALUMINUM AND STEEL COL. SIZES | 8 | 9 | 10 | 11 | 16 | 19 |
|-------------------------------|--------------------|-----------------|------------------------|-------------------------|-----------------|-----------------|
| | 3" x 3" AL. FLUTED | 3" x 3" AL. BOX | 3" x 3" AL. CLOVERLEAF | 3" x 3" STL. CLOVERLEAF | 4" x 4" AL. BOX | 3" x 3" AL. BOX |
| COL. HEIGHT | COLUMN CAPACITY | | | | | |
| 8' - 0" | 3,804 | 6,933 | 5,708 | 10,474 | 13,641 | 8,139 |
| 8' - 6" | 3,714 | 6,765 | 5,564 | 9,770 | 13,415 | 7,801 |
| 9' - 0" | 3,624 | 6,597 | 5,421 | 9,075 | 13,188 | 7,741 |
| 10' - 0" | 3,039 | 5,414 | 4,260 | 7,732 | 12,736 | 6,294 |
| 11' - 0" | 2,511 | 4,474 | 3,521 | 6,464 | 12,283 | 5,202 |
| 12' - 0" | 2,110 | 3,760 | 2,958 | 5,432 | 11,831 | 4,371 |
| 13' - 0" | 1,798 | 3,203 | 2,521 | 4,628 | 11,379 | 3,724 |

FREESTANDING COLUMN SCHEDULE

| ALUMINUM AND STEEL COL. SIZES | 8 | 9 | 10 | 11 | 16 | 19 |
|-------------------------------|--------------------|-----------------|------------------------|-------------------------|-----------------|-----------------|
| | 3" x 3" AL. FLUTED | 3" x 3" AL. BOX | 3" x 3" AL. CLOVERLEAF | 3" x 3" STL. CLOVERLEAF | 4" x 4" AL. BOX | 3" x 3" AL. BOX |
| COL. HEIGHT | COLUMN CAPACITY | | | | | |
| 8' - 0" | 1,187 | 2,115 | 1,664 | 3,055 | 6,726 | 2,459 |
| 8' - 6" | 1,051 | 1,873 | 1,474 | 2,707 | 5,958 | 2,142 |
| 9' - 0" | 938 | 1,671 | 1,315 | 2,414 | 5,314 | 1,943 |
| 10' - 0" | 760 | 1,353 | 1,065 | 1,955 | 4,304 | 1,574 |
| 11' - 0" | 628 | 1,119 | 880 | 1,616 | 3,557 | 1,300 |
| 12' - 0" | 528 | 940 | 740 | 1,358 | 2,989 | 1,093 |
| 13' - 0" | 450 | 801 | 630 | 1,157 | 2,547 | 931 |

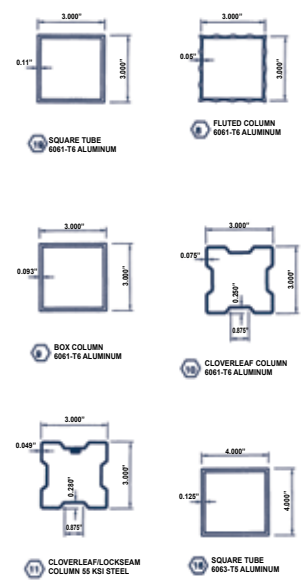

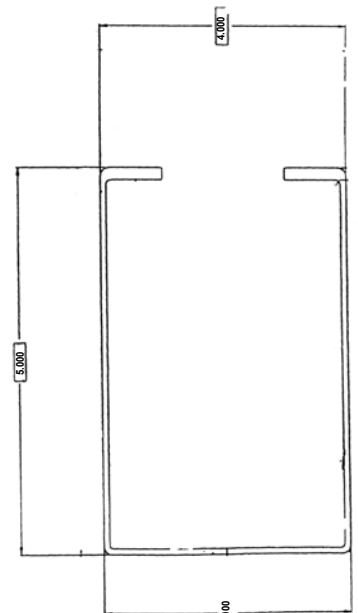
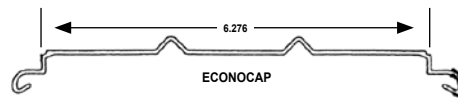
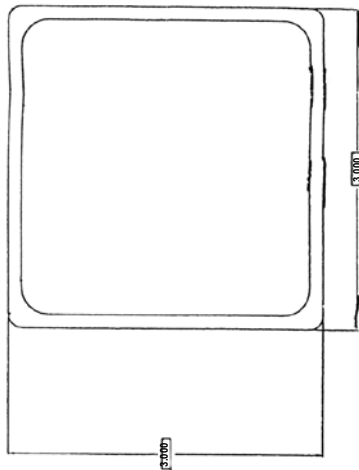
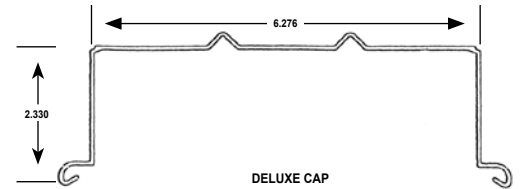
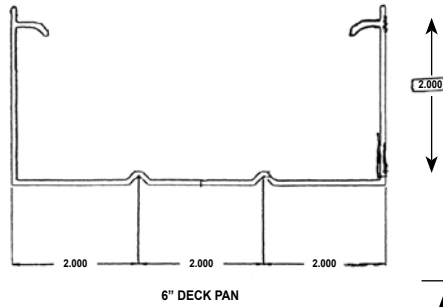

COLUMNS
ALSO AVAILABLE:
4" x 4" x .125
6" x 6" x .125
4" x 8" x .125
6" x 10" x .125

FASCIA/GUTTER
ALSO AVAILABLE:
4" x 7"
3" x 6"
3" x 5"

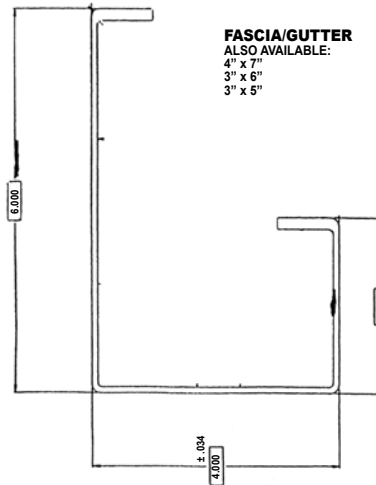

DRAIN BEAMS
ALSO AVAILABLE:
4" x 4" x .150
4" x 6" x .150
4" x 8" x .150
6" x 10" x .150



Other Ballew's Products

- Screened porch enclosures
- Mobile home roof-overs
- Full line of stepdown products for window awnings and door hoods
- Two styles of insulated covers
- Screened pool enclosures
- Extruded aluminum canopies

Manufacturer

Ballew's Aluminum Products, Inc. was established on quality and service in 1958. Ballew's Aluminum Products, Inc. is a manufacturer of residential, commercial, and industrial canopies. All roofing systems are pre-cut to job specifications for accurate and efficient installation. Ballew's roofing panels, as well as built-in gutter systems, come in a variety of profiles, thicknesses, and colors to fulfill a broad range of applications.

Ballew's Aluminum Products, Inc. offers the benefit of economically priced material, versatile application, and durable performance.

Part 1 – General-Pages 1-8 of Ballew’s Engineering Data

1.1 SUMMARY

A. This section of Ballew’s Aluminum Products Engineering Data gives the following Data:

1. Cross section and properties
2. Restrained beam schedule/Post under beams
3. Minimum deck slope in inches per foot for live load
4. Concrete footings and related slabs.
Cylindrical and cube footings are noted.
5. Soil types specifications are noted.
6. Freestanding beam schedule – Post under beams.
7. Column load schedule and conditions.
8. Load tables for 12” x 2.5” w-pan units
9. Load tables for 12” x 3” flat pan units.
10. Overhead support system for marquees.

B. All structures shown on plans, drawings, and pictures shall be furnished by Ballew’s Aluminum Products, Inc., P.O. Box 27174, Greenville, SC 29616-2174.

C. Part 1 – General-Pages 1-8 specifies pre-fabricated overhead structures providing protection such as walkway covers, canopies, carports and other systems as manufactured by Ballew’s Aluminum Products Inc., instructions.

1.2 SUBMITTALS

A. Provide shop drawings and supply product data as needed to clearly define material and installation details.

B. Samples of Aluminum finishes for roof panels and all support structures will be provided as needed.

1.2 QUALITY ASSURANCE

A. If installation assistance is needed, Ballew’s Aluminum Products, Inc. will recommend qualified installers. Canopies shall be installed according to approved plans and shop drawings.

1.4 ENGINEERS DATA

A. Engineering data is available from Ballew’s Aluminum Products, Inc. Engineering data includes 10, 20, 30 and 40 P.S.F Design live load and snow load charts, includes design wind loads of 100 - 140 MPH.

B. Compliance with local codes can be verified through Ballew’s Aluminum Products.

1.5 DELIVERY-STORAGE AND HANDLING

A. Delivery, storage and handling of covered walkway and carport systems components as recommended by the manufacturer.

2.2 MATERIAL

A. Aluminum extrusion: Alloy 6061-T, 6063-T6 as called by profile design.

B. Aluminum sheeting: Roll formed roof panels alloy 3004-H-36 or equivalent. Minimum yield 28,000 KSI.

C. Hardware: will be plated non-corrosive as selected by Ballew’s Aluminum Products, Inc.

D. Sealants and other non-structural items: As per Ballew’s Aluminum Products, Inc.

2.3 FINISHES

A. Aluminum extrusions:

1. Painted finish: Baked on enamel finish as outlined in AAMA Publication 603.8-85. Color selection as per Ballew’s Aluminum Products, Inc.

B. Aluminum Sheeting: Factory finished with chemical cleaning, conversion coating and baked on polyester coating. Color selection by Ballew’s Aluminum Products, Inc.

C. All other finishes that are requested should be cleared by Ballew’s Aluminum Products, Inc.

2.4 FABRICATION

A. Roof Panels: Roll-formed Aluminum panels with interlocking seams as noted in engineered drawings:

1. Ballew’s flat pan: 12” x 3”
2. Ballew’s roof-over pan: 12” x 1 1/4”
3. Ballew’s w-pan: 12” x 2 1/2”

B. Fascias, columns and beams: Extrusions and roll formed sections of sizes and shapes indicated on engineered drawings.

1. Fabricated, bored and notched for mechanical connection.
2. Provide notches, cut out, and internal deflectors in members as noted to act as internal water drainage system.

Part 3 – Execution

3.1 INSPECTION

A. Prior to actual start of work that soil conditions and surrounding conditions are acceptable.

B. Contractors shall field check dimensions and heights as noted on drawings prior to fabrication by Ballew’s Aluminum Products, Inc.

3.2 INSTALLATION

A. Install pre-fabricated protective covers with connectors sealants and fasteners in accordance with manufacturers instructions and shop drawings.

Components

- All components are pre-engineered to meet SSBC for live load, wind load, deflection limit and snow loads.
- Components meet all standard building codes and wind uplift conditions.
- W pans and high rise pans are available in .025, .032, .040 roll-formed aluminum and 26 gauge steel.
- Factory prefabricated for time effectiveness and ease of installation.
- Available in many colors (see chart).
- All aluminum extrusions shall be alloy indicated.
- Aluminum roof-panels and gutters shall be 3004-H-36 alloy or equivalent.
- Screws and bolts shall be 2024-T-4 aluminum alloy or stainless steel or cadmium plated ASTM steel.
- Thickness noted are for bare metal. Underrun tolerance is -5%.
- Aluminum beams are baked-on enamel white, ivory, or bronze.
- Roll-formed or extruded internal drainage system.

Color Selection

- | | |
|-------------------------------------|-----------------------------------|
| I – Lockseam aluminum posts | E – 3” Extruded .110 Smooth Posts |
| A – W-Pans (2 1/2 in. x 12 in.) | F – 4” Extruded .125 Smooth Posts |
| B – High Rise Pans (3 in. x 12 in.) | G – Roll Formed Structural Gutter |
| C – Extruded Aluminum Beams | H – Extruded .080 Gutter |
| D – 3” Lockseam Steel Posts | |

White
A, B, C, D, E, F, G, H, I

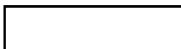

Ivory
A, B, C, D, E, F, G, H, I



Bronze
A, B, C, D, E, F, G, H



Autumn Brown
A, B, D, G



Cadet Gray
A, B, D, G



Clay
G, I



Black
G, I



Light Brown
G, I



Ivy Green
G, I



Woodgrain
G, I



Terra Cotta
G, I

